

The stiffest and most aerodynamic integrated handlebar and stem system

670-0070001030	100mmx400W	670-0070004030	120mmx420W
670-0070015030	110mmx400W	670-0070009030	130mmx420W
670-0070007030	120mmx400W	670-0070013030	100mmx440W
670-0070014030	130mmx400W	670-0070008030	110mmx440W
670-0070002030	100mmx420W	670-0070005030	120mmx440W
670-0070003030	110mmx420W	670-0070006030	130mmx440W

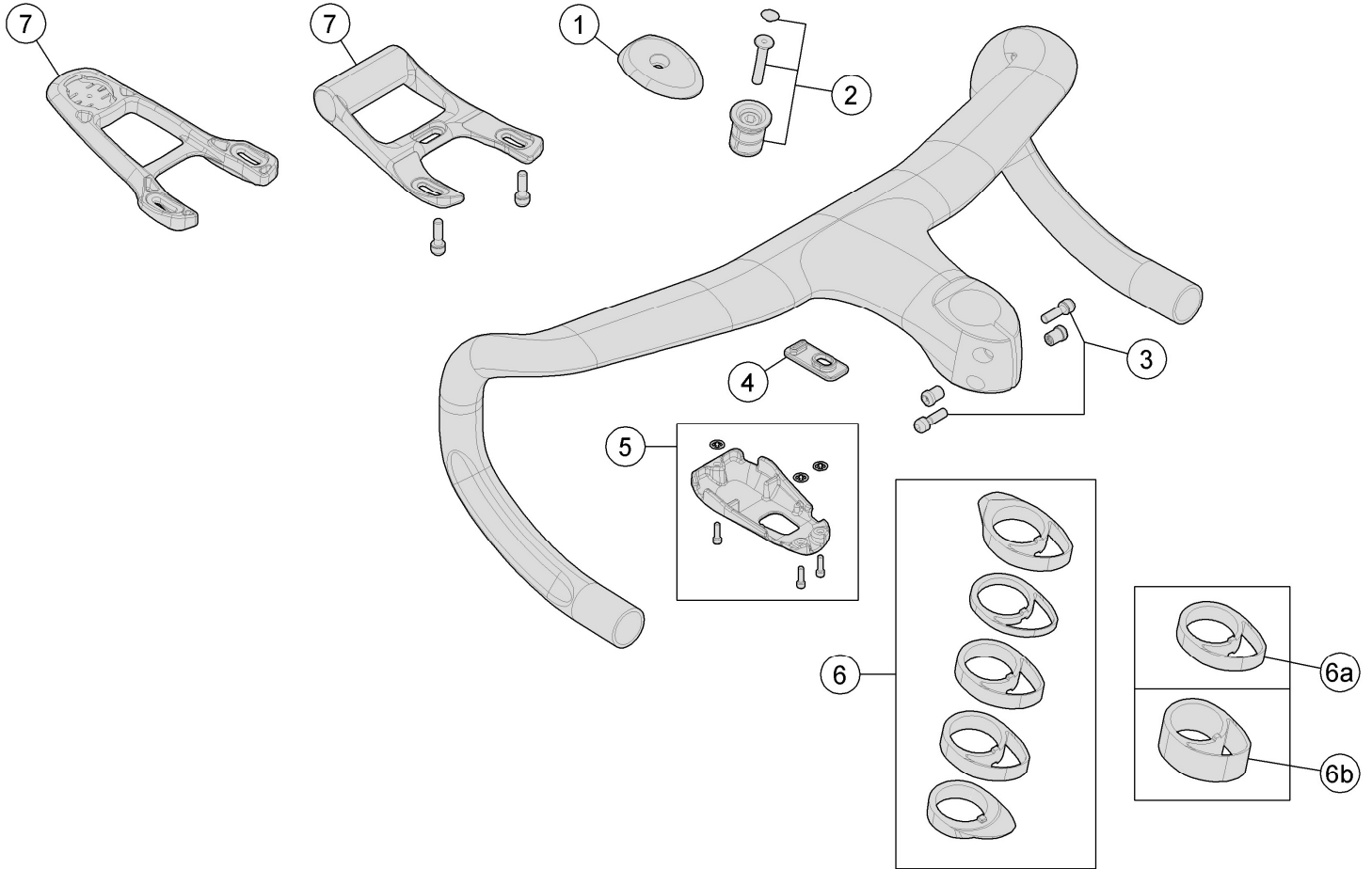

Item No.	FSA Code No.	Description	Notes
1	670-0124000030	V4041 Carbon Top Cap	
2	160-0050000021	TH-863-1 + MS086 Compression Device	
3	670-0125000000	(ML250+ML294)x2 Stem Hardware Kit	
4	670-0126000110	MS061 Rubber Insert	For use with Di2 3-port junction box
5	670-0127000110	E0631 Lower Cover + ML540x3 Cover Screws M3 + ML542x3 Washers	
6	670-0128000030	MW082x1, MW081Ax1, MW081Bx2, MW052x1 Aero Spacer Kit x5 pcs	★Standard accessory; MW082 not for use with 100mm stem
7	187-0006000110	EL259 Control Center Bracket with ML541 M5 bolts	★For standard computer mount

★ Optional Parts

Item No.	FSA Code No.	Description	Notes
6a	670-0097000031	MW081B Aero Spacer 10 mm x1 pcs	
6b	670-0097000032	MW081C Aero Spacer 20 mm x1 pcs	
7	187-0005000110	EL258 Control Center Bracket with ML541 M5 bolts	For Garmin computer mount