

# CHAMBER HV™

Floor pump

Part# 7074794

FIGURE 1

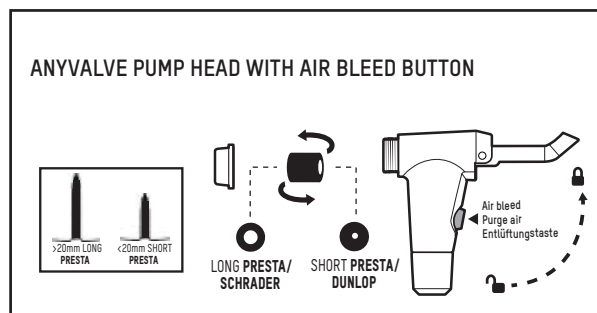

## INSTRUCTIONS FOR TIRE INFLATION

1. Remove the dust cap from your tire valve. If you have Presta valves, unscrew the metal locking barrel at the tip of the valve.
2. Push in the tip of either valve type to ensure that the valve isn't stuck and to blow out any dirt.
3. Choose the correct pump head insert for your valve type (FIGURE 1). If necessary, unscrew cap and reverse rubber insert.
4. Press pump head onto valve and lift the lever to lock.
5. Inflate to desired air pressure. DO NOT OVERINFLATE TIRE.
6. If necessary depress the air bleed valve on the pump head to release air until the desired pressure is achieved.
7. Press pump head lever down and remove.
8. If using Presta valves, screw the locking barrel until tight.
9. Replace the tire valve dust cap.

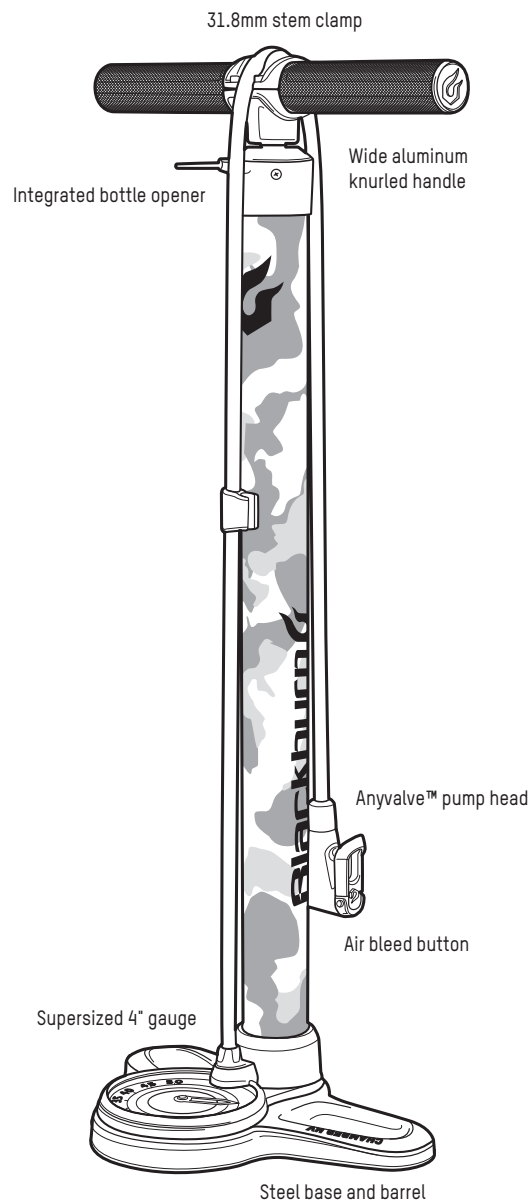

**WARNING:** NEVER OVERINFLATE YOUR TIRE. SEE TIRE SIDEWALL FOR MANUFACTURER RECOMMENDED TIRE INFLATION PSI.

Visit us at [blackburndesign.com](http://blackburndesign.com) for product updates.

**Blackburn**

Customer Service: 1-800-456-2355  
Blackburndesign.com  
Printed in China

**LIFETIME  
WARRANTY**